

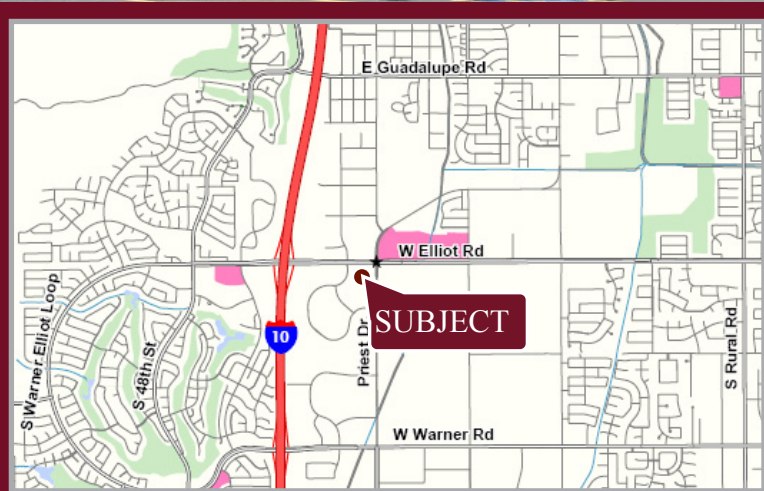

COSTCO PLAZA

SOUTHEAST CORNER OF PRIEST DR. & ELLIOT RD., TEMPE, AZ



AVAILABILITY

- 2,000 sf
- 25,760 sf

FEATURES

- Large customer draw with Costco and The Dump (Now Open!)
- Over 68,000 employees within a 3 mile radius
- Freeway power center 1/2 mile from I-10 Interchange

NOTABLE TENANTS



2010 Demographics	1 MILE	3 MILE	5 MILE
Estimated Population	12,028	115,166	288,437
Ave Household Income	\$66,380	\$81,206	\$82,538
Daytime Employment	14,241	69,296	191,408

Information contained herein is believed to be accurate but is not warranted as to accuracy and may change or be updated without notice. Seller or landlord makes no representation as to the environmental condition of the property and recommends purchaser's or tenant's independent investigation.

EXCLUSIVELY REPRESENTED BY



STRATEGIC
RETAIL GROUP

JASON FESSINGER
602.778.3833
jasonf@srgaz.com

MATT MILINOVICH
602.778.3830
mattm@srgaz.com

BRIAN GAST
602.792.5201
briang@srgaz.com

15169 N. Scottsdale Road Suite 330 Scottsdale, AZ 85254 602.778.3838(p) 602.778.3839(f)



COSTCO PLAZA

SOUTHEAST CORNER OF PRIEST DR. & ELLIOT RD., TEMPE, AZ



#	TENANT	SQ. FT.
1	Kyoto Bowl	2,575 sf
2	Supercuts	1,300 sf
3-4	Shasta Pools	2,585 sf
5	Furnish 123	5,100 sf
6	Pecos Tile	12,276 sf
7	Guitar Center	14,500 sf
8	Available	2,000 sf
9	Mattress Manufacturers	4,500 sf
10	Furniture	10,000 sf
11	Available	25,760 sf

Information contained herein is believed to be accurate but is not warranted as to accuracy and may change or be updated without notice. Seller or landlord makes no representation as to the environmental condition of the property and recommends purchaser's or tenant's independent investigation.

EXCLUSIVELY REPRESENTED BY



STRATEGIC
RETAIL GROUP

JASON FESSINGER
602.778.3833
jasonf@srgaz.com

MATT MILINOVICH
602.778.3830
mattm@srgaz.com

BRIAN GAST
602.792.5201
briang@srgaz.com

EXPANDED PROFILE

1990 - 2000 Census, 2010 Estimates with 2015 Projections

Calculated using Proportional Block Groups

Prepared For

Prepared By

Lat/Lon: 33.34916/-111.9632

Priest & Elliot Rd.

Tempe, AZ

	1 Mile		3 Miles		5 Miles	
Population (2010)						
Estimated Population	12,028		115,166		288,437	
Census Population (1990)	6,220		75,412		188,041	
Census Population (2000)	10,720		104,966		258,913	
Projected Population (2015)	14,972		121,884		302,803	
Forecasted Population (2020)	17,332		131,510		327,365	
Historical Annual Growth (1990 to 2000)	4,499	7.23%	29,554	3.92%	70,871	3.77%
Historical Annual Growth (2000 to 2010)	1,308	1.22%	10,200	0.97%	29,524	1.14%
Projected Annual Growth (2010 to 2015)	2,945	4.90%	6,718	1.17%	14,367	1.00%
Estimated Population Density	3,832	<i>psm</i>	4,075	<i>psm</i>	3,675	<i>psm</i>
Trade Area Size	3.14	<i>sq mil</i>	28.26	<i>sq mil</i>	78.49	<i>sq mil</i>
Households (2010)						
Estimated Households	4,947		43,911		103,799	
Census Households (1990)	2,538		29,356		69,367	
Census Households (2000)	4,550		41,878		97,887	
Projected Households (2015)	6,216		46,329		108,506	
Forecasted Households (2020)	7,138		48,862		114,418	
Households with Children	1,321	26.69%	13,304	30.30%	34,655	33.39%
Average Household Size	2.43		2.61		2.75	
Average Household Income (2010)						
Est. Average Household Income	\$66,380		\$81,206		\$82,538	
Proj. Average Household Income (2015)	\$73,562		\$87,830		\$89,465	
Average Family Income	\$79,344		\$99,503		\$97,844	
Median Household Income (2010)						
Est. Median Household Income	\$52,816		\$67,836		\$68,954	
Proj. Median Household Income (2015)	\$55,956		\$70,589		\$72,035	
Median Family Income	\$64,272		\$82,806		\$82,281	
Per Capita Income (2010)						
Est. Per Capita Income	\$27,445		\$31,216		\$30,070	
Proj. Per Capita Income (2015)	\$30,660		\$33,632		\$32,422	
Per Capita Income Est. 5 year change	\$3,215	11.71%	\$2,416	7.74%	\$2,352	7.82%
Other Income (2010)						
Est. Median Disposable Income	\$44,063		\$55,049		\$55,930	
Proj. Median Disposable Income (2015)	\$46,819		\$57,130		\$58,168	
Disposable Income Est. 5 year change	\$2,756	6.25%	\$2,081	3.78%	\$2,239	4.00%
Est. Average Household Net Worth	\$385,393		\$515,478		\$533,902	
Daytime Demos (2010)						
Total Number of Businesses	679		4,343		11,365	
Total Number of Employees	14,241		69,296		191,408	
Company Headqtrs: Businesses	1	0.20%	9	0.21%	31	0.28%
Company Headqtrs: Employees	1	0.01%	395	0.57%	3,313	1.73%
Unemployment Rate	6.22%		4.70%		4.69%	
Employee Population per Business	21.0 to 1		16.0 to 1		16.8 to 1	
Residential Population per Business	17.7 to 1		26.5 to 1		25.4 to 1	

This report was produced using data from private and government sources deemed to be reliable. The information herein is provided without representation or warranty.

EXPANDED PROFILE

1990 - 2000 Census, 2010 Estimates with 2015 Projections

Calculated using Proportional Block Groups

Prepared For

Prepared By

Lat/Lon: 33.34916/-111.9632

Priest & Elliot Rd.

Tempe, AZ

Race & Ethnicity (2010)

	1 Mile		3 Miles		5 Miles	
White	8,940	74.33%	94,555	82.10%	238,507	82.69%
Black or African American	1,093	9.09%	7,352	6.38%	21,035	7.29%
American Indian & Alaska Native	1,126	9.37%	4,594	3.99%	7,727	2.68%
Asian	619	5.14%	6,607	5.74%	15,778	5.47%
Hawaiian & Pacific Islander	34	0.28%	354	0.31%	928	0.32%
Other Race	148	1.23%	1,182	1.03%	3,204	1.11%
Two or More Races	68	0.57%	521	0.45%	1,257	0.44%
Not Hispanic or Latino Population	8,227	68.40%	84,883	73.71%	212,622	73.72%
Hispanic or Latino Population	3,801	31.60%	30,283	26.29%	75,815	26.28%
Not of Hispanic Origin Population (1990)	4,527	72.78%	64,516	85.55%	164,373	87.41%
Hispanic Origin Population (1990)	1,693	27.22%	10,896	14.45%	23,668	12.59%
Not Hispanic or Latino Population (2000)	8,163	76.15%	86,171	82.09%	213,721	82.55%
Hispanic or Latino Population (2000)	2,556	23.85%	18,795	17.91%	45,191	17.45%
Not Hispanic or Latino Population (2015)	9,955	66.49%	86,048	70.60%	213,132	70.39%
Hispanic or Latino Population (2015)	5,017	33.51%	35,836	29.40%	89,671	29.61%
Hist. Hispanic Ann Growth (1990 to 2010)	2,107	6.22%	19,387	8.90%	52,147	11.02%
Proj. Hispanic Ann Growth (2015 to 2010)	1,216	6.40%	5,554	3.67%	13,856	3.66%

Age Distribution (2010)

0 to 4 yrs	956	7.95%	8,197	7.12%	20,544	7.12%
5 to 9 yrs	867	7.21%	8,227	7.14%	21,700	7.52%
10 to 14 yrs	715	5.94%	7,745	6.72%	20,831	7.22%
15 to 19 yrs	801	6.66%	7,786	6.76%	20,950	7.26%
20 to 24 yrs	1,513	12.58%	9,680	8.41%	22,874	7.93%
25 to 29 yrs	1,386	11.52%	9,738	8.46%	22,865	7.93%
30 to 34 yrs	1,095	9.11%	9,212	8.00%	22,415	7.77%
35 to 39 yrs	814	6.77%	8,967	7.79%	22,857	7.92%
40 to 44 yrs	741	6.16%	8,887	7.72%	22,707	7.87%
45 to 49 yrs	731	6.08%	8,710	7.56%	21,992	7.62%
50 to 54 yrs	614	5.10%	7,431	6.45%	18,939	6.57%
55 to 59 yrs	495	4.11%	5,859	5.09%	14,749	5.11%
60 to 64 yrs	399	3.32%	4,441	3.86%	11,004	3.81%
65 to 74 yrs	490	4.07%	5,701	4.95%	13,577	4.71%
75 to 84 yrs	289	2.41%	3,136	2.72%	7,140	2.48%
85 yrs plus	122	1.02%	1,448	1.26%	3,294	1.14%
Median Age	29.51 yrs		33.46 yrs		32.99 yrs	

Gender Age Distribution (2010)

Female Population	6,036	50.18%	56,841	49.36%	141,942	49.21%
0 to 19 yrs	1,643	27.23%	15,563	27.38%	41,168	29.00%
20 to 64 yrs	3,887	64.40%	35,559	62.56%	87,545	61.68%
65 yrs plus	505	8.37%	5,719	10.06%	13,229	9.32%
Female Median Age	30 yrs		34 yrs		34 yrs	
Male Population	5,992	49.82%	58,325	50.64%	146,495	50.79%
0 to 19 yrs	1,695	28.29%	16,393	28.11%	42,857	29.25%
20 to 64 yrs	3,900	65.09%	37,367	64.07%	92,856	63.39%
65 yrs plus	396	6.61%	4,566	7.83%	10,782	7.36%
Male Median Age	29.12 yrs		32.73 yrs		32.27 yrs	

This report was produced using data from private and government sources deemed to be reliable. The information herein is provided without representation or warranty.

EXPANDED PROFILE

1990 - 2000 Census, 2010 Estimates with 2015 Projections

Calculated using Proportional Block Groups

Prepared For

Prepared By

Lat/Lon: 33.34916/-111.9632

Priest & Elliot Rd.

Tempe, AZ

Household Income Distribution (2010)

	1 Mile		3 Miles		5 Miles	
\$200,000 or More	85	1.71%	1,607	3.66%	3,698	3.56%
\$150,000 to \$199,999	178	3.59%	2,289	5.21%	5,746	5.54%
\$100,000 to \$149,999	766	15.48%	7,178	16.35%	18,363	17.69%
\$75,000 to \$99,999	512	10.34%	6,864	15.63%	16,690	16.08%
\$50,000 to \$74,999	1,009	20.40%	9,386	21.38%	22,310	21.49%
\$35,000 to \$49,999	870	17.58%	6,380	14.53%	14,364	13.84%
\$25,000 to \$34,999	589	11.90%	4,247	9.67%	8,918	8.59%
\$15,000 to \$24,999	373	7.54%	2,974	6.77%	6,604	6.36%
\$0 to \$14,999	567	11.45%	2,986	6.80%	7,105	6.85%
\$35,000+	3,419	69.10%	33,704	76.75%	81,172	78.20%
\$75,000+	1,540	31.13%	17,938	40.85%	44,497	42.87%

Housing (2010)

Total Housing Units	5,678		47,829		112,440	
Housing Units, Occupied	4,947	87.13%	43,911	91.81%	103,799	92.32%
<i>Housing Units, Owner-Occupied</i>	1,621	32.76%	25,181	57.35%	64,028	61.68%
<i>Housing Units, Renter-Occupied</i>	3,327	67.24%	18,730	42.65%	39,771	38.32%
Housing Units, Vacant	731	12.87%	3,917	8.19%	8,641	7.68%
Median Years in Residence	2 yrs		3 yrs		3 yrs	

Marital Status (2010)

Never Married	4,398	46.35%	30,741	33.73%	74,501	33.00%
Now Married	3,275	34.52%	43,797	48.06%	112,366	49.76%
Separated	477	5.03%	3,586	3.94%	8,377	3.71%
Widowed	269	2.83%	3,228	3.54%	7,435	3.29%
Divorced	1,069	11.27%	9,776	10.73%	23,115	10.24%

Household Type (2010)

Population Family	8,027	66.74%	87,119	75.65%	224,572	77.86%
Population Non-Family	3,980	33.09%	27,702	24.05%	61,256	21.24%
Population Group Qtrs	21	0.18%	346	0.30%	2,609	0.90%
Family Households	2,256	45.60%	24,683	56.21%	62,224	59.95%
<i>Married Couple With Children</i>	632	19.29%	8,603	19.64%	22,824	20.31%
<i>Average Family Household Size</i>	3.6		3.5		3.6	
Non-Family Households	2,692	54.40%	19,229	43.79%	41,575	40.05%

Household Size (2010)

1 Person Household	1,977	39.95%	14,173	32.28%	30,347	29.24%
2 Person Households	1,202	24.29%	11,166	25.43%	25,422	24.49%
3 Person Households	547	11.05%	5,204	11.85%	12,937	12.46%
4 Person Households	661	13.36%	7,637	17.39%	19,920	19.19%
5 Person Households	303	6.13%	3,444	7.84%	9,046	8.71%
6+ Person Households	258	5.21%	2,288	5.21%	6,127	5.90%

Household Vehicles (2010)

Total Vehicles Available	8,153		79,110		192,291	
Household: 0 Vehicles Available	305	6.17%	1,945	4.43%	4,420	4.26%
Household: 1 Vehicles Available	2,372	47.95%	17,223	39.22%	37,759	36.38%
Household: 2+ Vehicles Available	2,270	45.89%	24,743	56.35%	61,620	59.36%
Average Vehicles Per Household	1.6		1.8		1.9	

This report was produced using data from private and government sources deemed to be reliable. The information herein is provided without representation or warranty.

EXPANDED PROFILE

1990 - 2000 Census, 2010 Estimates with 2015 Projections

Calculated using Proportional Block Groups

Prepared For

Prepared By

Lat/Lon: 33.34916/-111.9632

Priest & Elliot Rd.

Tempe, AZ

	1 Mile		3 Miles		5 Miles	
Labor Force (2010)						
Est. Labor: Population Age 16+	9,360		89,589		221,701	
Est. Civilian Employed	6,607	70.59%	62,138	69.36%	153,076	69.05%
Est. Civilian Unemployed	582	6.22%	4,209	4.70%	10,404	4.69%
Est. in Armed Forces	16	0.17%	93	0.10%	255	0.12%
Est. not in Labor Force	2,155	23.03%	23,149	25.84%	57,966	26.15%
Occupation (2000)						
Occupation: Population Age 16+	6,399		60,116		145,055	
Mgmt, Business, & Financial Operations	852	13.32%	10,506	17.48%	24,998	17.23%
Professional and Related	1,662	25.97%	15,298	25.45%	37,713	26.00%
Service	811	12.67%	6,930	11.53%	17,210	11.86%
Sales and Office	2,124	33.20%	18,132	30.16%	42,540	29.33%
Farming, Fishing, and Forestry	7	0.11%	30	0.05%	161	0.11%
Construct, Extraction, & Maintenance	389	6.07%	3,825	6.36%	9,274	6.39%
Production, Transp. & Material Moving	555	8.67%	5,395	8.97%	13,161	9.07%
Percent White Collar Workers	72.48%		73.09%		72.56%	
Percent Blue Collar Workers	27.52%		26.91%		27.44%	
Consumer Expenditure (2010)						
Total Household Expenditure	\$262 M		\$2.66 B		\$6.37 B	
Total Non-Retail Expenditures	\$151 M	57.52%	\$1.54 B	57.77%	\$3.68 B	57.81%
Total Retail Expenditures	\$111 M	42.48%	\$1.12 B	42.23%	\$2.69 B	42.19%
Apparel	\$12.6 M	4.81%	\$128 M	4.81%	\$307 M	4.81%
Contributions	\$9.26 M	3.54%	\$101 M	3.78%	\$241 M	3.78%
Education	\$6.38 M	2.43%	\$66.6 M	2.51%	\$160 M	2.52%
Entertainment	\$14.5 M	5.54%	\$149 M	5.61%	\$358 M	5.62%
Food And Beverages	\$40.5 M	15.46%	\$404 M	15.17%	\$966 M	15.15%
Furnishings And Equipment	\$11.4 M	4.34%	\$119 M	4.48%	\$287 M	4.50%
Gifts	\$6.81 M	2.60%	\$71.5 M	2.69%	\$171 M	2.69%
Health Care	\$16.0 M	6.12%	\$158 M	5.94%	\$376 M	5.91%
Household Operations	\$9.20 M	3.51%	\$97.8 M	3.67%	\$235 M	3.69%
Miscellaneous Expenses	\$4.42 M	1.69%	\$43.8 M	1.65%	\$105 M	1.64%
Personal Care	\$3.84 M	1.46%	\$38.6 M	1.45%	\$92.4 M	1.45%
Personal Insurance	\$2.62 M	1.00%	\$27.9 M	1.05%	\$66.9 M	1.05%
Reading	\$868 K	0.33%	\$8.76 M	0.33%	\$20.9 M	0.33%
Shelter	\$50.3 M	19.20%	\$514 M	19.30%	\$1.23 B	19.32%
Tobacco	\$1.74 M	0.66%	\$16.4 M	0.62%	\$39.0 M	0.61%
Transportation	\$52.7 M	20.13%	\$534 M	20.06%	\$1.28 B	20.08%
Utilities	\$18.7 M	7.16%	\$183 M	6.88%	\$437 M	6.85%
Educational Attainment (2010)						
Adult Population (25 Years or Older)	7,176		73,530		181,539	
Elementary (0 to 8)	463	6.45%	2,974	4.04%	7,460	4.11%
Some High School (9 to 11)	305	4.25%	3,464	4.71%	8,961	4.94%
High School Graduate (12)	1,379	19.21%	13,998	19.04%	34,113	18.79%
Some College (13 to 16)	1,632	22.75%	15,528	21.12%	39,478	21.75%
Associate Degree Only	502	7.00%	6,028	8.20%	15,116	8.33%
Bachelor Degree Only	1,950	27.18%	19,786	26.91%	47,046	25.91%
Graduate Degree	945	13.17%	11,753	15.98%	29,366	16.18%

This report was produced using data from private and government sources deemed to be reliable. The information herein is provided without representation or warranty.

EXPANDED PROFILE

1990 - 2000 Census, 2010 Estimates with 2015 Projections

Calculated using Proportional Block Groups

Prepared For

Prepared By

Lat/Lon: 33.34916/-111.9632

Priest & Elliot Rd.

Tempe, AZ

	1 Mile		3 Miles		5 Miles	
Units In Structure (2000)						
1 Detached Unit	1,778	35.40%	23,585	53.15%	63,787	61.91%
1 Attached Unit	322	6.40%	3,596	8.10%	7,384	7.17%
2 to 4 Units	234	4.67%	2,114	4.76%	4,430	4.30%
5 to 9 Units	601	11.97%	3,785	8.53%	7,227	7.01%
10 to 19 Units	656	13.07%	3,318	7.48%	6,181	6.00%
20 to 49 Units	376	7.48%	1,314	2.96%	2,576	2.50%
50 or more Units	1,008	20.07%	4,779	10.77%	8,931	8.67%
Mobile Home or Trailer	47	0.94%	1,886	4.25%	2,519	2.45%
Other Structure	-	-	-	-	5	-
Homes Built By Year						
1999 to 2000	284	5.66%	1,178	2.65%	3,121	3.03%
1995 to 1998	1,430	28.47%	7,538	16.99%	14,923	14.48%
1990 to 1994	852	16.97%	7,099	16.00%	16,074	15.60%
1980 to 1989	1,753	34.91%	16,044	36.15%	32,752	31.79%
1970 to 1979	512	10.19%	10,467	23.59%	24,739	24.01%
1960 to 1969	60	1.20%	1,280	2.88%	7,865	7.63%
1950 to 1959	60	1.20%	402	0.91%	2,519	2.44%
Built Before 1949	71	1.40%	369	0.83%	1,049	1.02%
Home Values (2000)						
\$1,000,000 or More	-	-	37	0.16%	104	0.18%
\$500,000 to \$999,999	-	-	442	1.96%	731	1.25%
\$400,000 to \$499,999	22	1.33%	437	1.94%	729	1.25%
\$300,000 to \$399,999	61	3.65%	979	4.35%	2,229	3.81%
\$200,000 to \$299,999	244	14.74%	3,275	14.56%	8,199	14.02%
\$150,000 to \$199,999	327	19.72%	4,703	20.91%	13,098	22.39%
\$100,000 to \$149,999	664	40.01%	8,266	36.75%	22,969	39.27%
\$70,000 to \$99,999	207	12.47%	3,335	14.83%	8,347	14.27%
\$50,000 to \$69,999	57	3.45%	697	3.10%	1,420	2.43%
\$25,000 to \$49,999	39	2.35%	190	0.84%	452	0.77%
\$0 to \$24,999	38	2.28%	131	0.58%	213	0.36%
Owner Occupied Median Home Value	\$146,071		\$162,032		\$156,679	
Renter Occupied Median Rent	\$722		\$753		\$750	
Average Property Value (2010)	\$285,005		\$219,460		\$218,185	
Transportation To Work (2000)						
Drive to Work Alone	4,865	75.89%	47,575	79.01%	113,037	77.78%
Drive to Work in Carpool	948	14.79%	7,255	12.05%	17,736	12.20%
Travel to Work - Public Transportation	71	1.10%	1,051	1.75%	2,532	1.74%
Drive to Work on Motorcycle	54	0.84%	289	0.48%	711	0.49%
Walk or Bicycle to Work	251	3.91%	1,728	2.87%	4,902	3.37%
Other Means	72	1.13%	402	0.67%	1,008	0.69%
Work at Home	150	2.34%	1,913	3.18%	5,408	3.72%
Travel Time (2000)						
Travel to Work in 14 Minutes or Less	1,652	26.39%	16,331	28.01%	38,779	27.71%
Travel to Work in 14 to 29 Minutes	2,756	44.01%	25,155	43.15%	59,984	42.87%
Travel to Work in 30 to 59 Minutes	1,635	26.11%	14,641	25.11%	36,205	25.87%
Travel to Work in 60 Minutes or More	218	3.49%	2,173	3.73%	4,957	3.54%
Average Travel Time to Work	21.5 mins		21.4 mins		21.4 mins	

This report was produced using data from private and government sources deemed to be reliable. The information herein is provided without representation or warranty.