

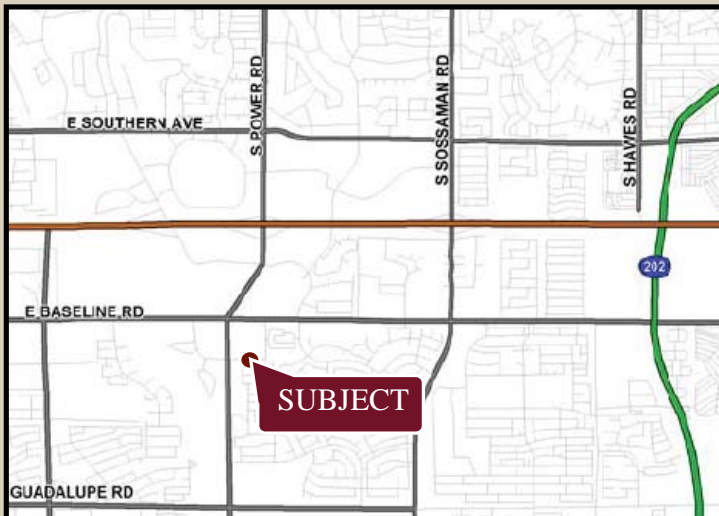

# KIOWA VILLAGE

SOUTH OF THE SOUTHEAST CORNER OF POWER RD. & BASELINE RD., MESA, AZ



### AVAILABILITY

- 1,387 SF UP TO 5,042 SF AVAILABLE
- 4,224 SF AVAILABLE

### FEATURES

- Located in the Superstition Springs Mall trade area
- Just south of the US 60 Freeway
- Established trade area within dense population
- Good incomes and strong daytime population

### TRAFFIC COUNTS:

- Power Road-46,000 cars per day
- Baseline Road-25,000 cars per day

2009 Demographics	1 MILE	3 MILE	5 MILE
Estimated Population	11,172	93,319	274,466
Ave Household Income	\$78,404	\$64,633	\$65,530
Daytime Employment	10,275	34,233	63,659

Information contained herein is believed to be accurate but is not warranted as to accuracy and may change or be updated without notice. Seller or landlord makes no representation as to the environmental condition of the property and recommends purchaser's or tenant's independent investigation.

EXCLUSIVELY REPRESENTED BY



**BILL FINCH**  
602.792.5202  
billf@srgaz.com

**JASON FESSINGER**  
602.778.3833  
jasonf@srgaz.com

**MATT MILINOVICH**  
602.778.3830  
mattm@srgaz.com

# KIOWA VILLAGE

SOUTH OF THE SOUTHEAST CORNER OF POWER RD. & BASELINE RD., MESA, AZ

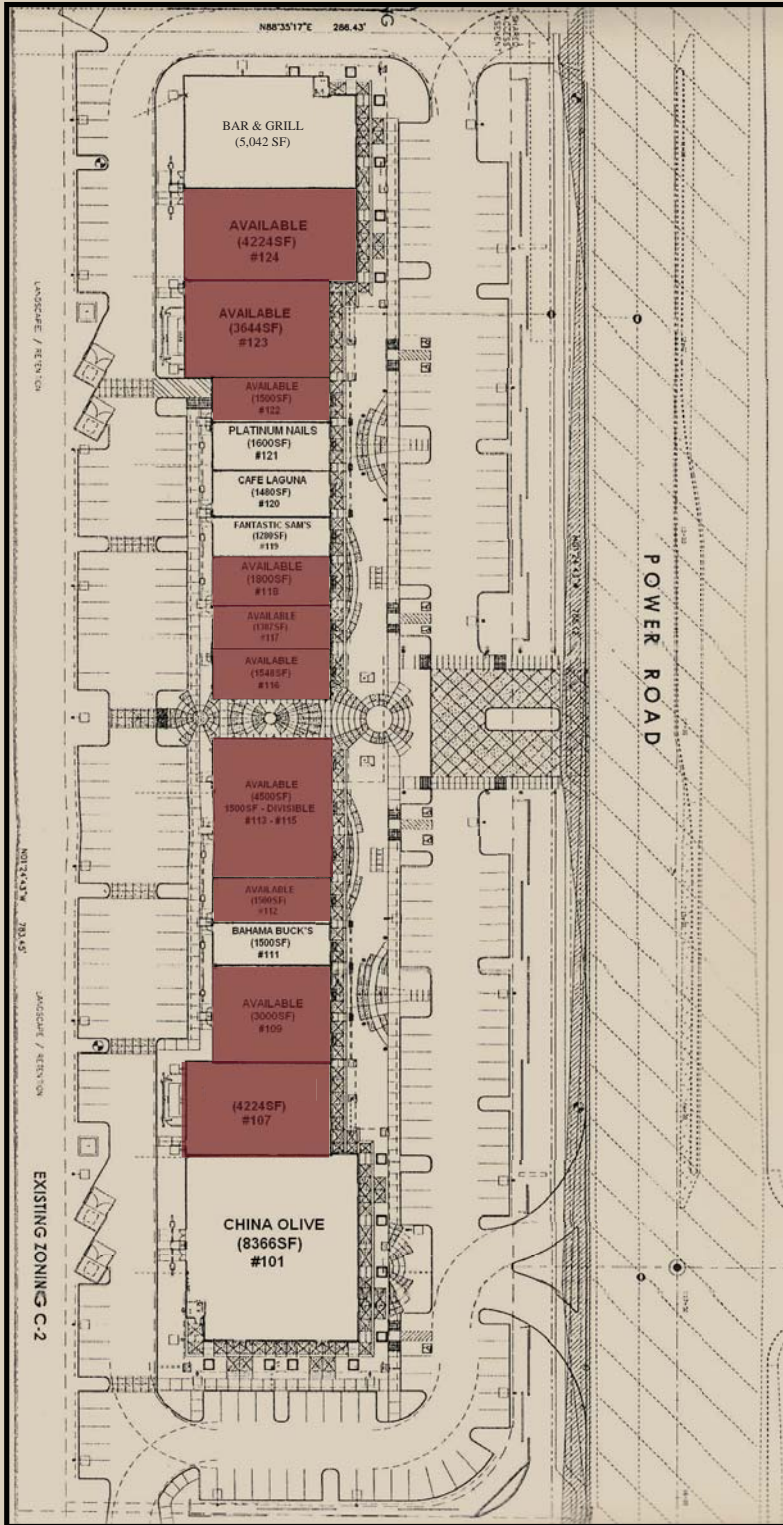

#	TENANT	SQ. FT.
101	China Olive	8,366 sf
107	Available	4,224 sf
108	Available	3,000 sf
111	Bahama Buck's	1,500 sf
112	Available	1,500 sf
113-115	Available-Divisible	4,500 sf
116	Available	1,548 sf
117	Available	1,387 sf
118	Available	1,800 sf
119	Fantastic Sam's	1,280 sf
120	Cafe Laguna	1,480 sf
121	Platinum Nails	1,600 sf
122	Available	1,500 sf
123	Available	3,644 sf
124	Available	4,224 sf
127	Bar & Grill	5,042 sf



Information contained herein is believed to be accurate but is not warranted as to accuracy and may change or be updated without notice. Seller or landlord makes no representation as to the environmental condition of the property and recommends purchaser's or tenant's independent investigation.

EXCLUSIVELY REPRESENTED BY



**STRATEGIC**  
RETAIL GROUP

**BILL FINCH**  
602.792.5202  
billf@srgaz.com

**JASON FESSINGER**  
602.778.3833  
jasonf@srgaz.com

**MATT MILINOVICH**  
602.778.3830  
mattm@srgaz.com

# DEMOGRAPHIC PROFILE EXPANDED

1990 - 2000 Census, 2009 Estimates & 2014 Projections

Calculated using Proportional Block Groups

Prepared For



Lat/Lon: 33.379248/-111.688191

February 2010

RF5

S Power Rd & E Baseline Rd Mesa, Arizona	1.00 mi radius		3.00 mi radius		5.00 mi radius	
<b>Population</b>						
Estimated Population (2009)	11,172		93,319		274,466	
Census Population (1990)	849		31,315		103,035	
Census Population (2000)	9,834		66,253		190,376	
Projected Population (2014)	11,638		110,339		318,194	
Forecasted Population (2019)	12,638		134,816		389,162	
Historical Annual Growth (1990 to 2000)	8,985	105.9%	34,937	11.2%	87,341	8.5%
Historical Annual Growth (2000 to 2009)	1,338	1.5%	27,067	4.5%	84,090	4.9%
Projected Annual Growth (2009 to 2014)	466	0.8%	17,020	3.6%	43,728	3.2%
Est. Population Density (2009)	3,558.03 <i>psm</i>		3,302.53 <i>psm</i>		3,499.81 <i>psm</i>	
Trade Area Size	3.14 <i>sq mi</i>		28.26 <i>sq mi</i>		78.42 <i>sq mi</i>	
<b>Households</b>						
Estimated Households (2009)	3,391		33,608		94,799	
Census Households (1990)	368		14,044		41,445	
Census Households (2000)	3,186		26,956		73,406	
Projected Households (2014)	3,330		36,146		101,840	
Forecasted Households (2019)	5,178		56,213		158,374	
Households with Children (2009)	1,586	46.8%	9,983	29.7%	32,479	34.3%
Average Household Size (2009)	3.29		2.74		2.87	
<b>Average Household Income</b>						
Est. Average Household Income (2009)	\$78,404		\$64,633		\$65,530	
Proj. Average Household Income (2014)	\$82,496		\$70,579		\$70,634	
Average Family Income (2009)	\$81,307		\$74,421		\$74,870	
<b>Median Household Income</b>						
Est. Median Household Income (2009)	\$76,891		\$61,489		\$63,386	
Proj. Median Household Income (2014)	\$82,259		\$69,019		\$69,637	
Median Family Income (2009)	\$81,125		\$70,753		\$72,425	
<b>Per Capita Income</b>						
Est. Per Capita Income (2009)	\$23,885		\$23,787		\$22,901	
Proj. Per Capita Income (2014)	\$23,689		\$23,551		\$22,836	
Per Capita Income Est. 5 year change	-\$196	-0.8%	-\$237	-1.0%	-\$65	-0.3%
<b>Other Income</b>						
Est. Median Disposable Income (2009)	\$61,698		\$50,388		\$51,819	
Est. Median Disposable Income (2014)	\$65,481		\$55,887		\$56,242	
Disposable Income Est. 5 year change	\$3,784	6.1%	\$5,499	10.9%	\$4,423	8.5%
Est. Average Household Net Worth (2009)	\$581,032		\$509,382		\$512,260	
<b>Daytime Demos</b>						
Total Number of Businesses (2009)	609		2,465		5,546	
Total Number of Employees (2009)	10,275		34,233		63,659	
Company Headqtrs: Businesses (2009)	0	0	2	0.1%	7	0.1%
Company Headqtrs: Employees (2009)	0	0	134	0.4%	266	0.4%
Unemployment Rate (2009)	2.90%		3.20%		3.60%	
Employee Population per Business	16.9 to 1		13.9 to 1		11.5 to 1	
Residential Population per Business	18.3 to 1		37.9 to 1		49.5 to 1	

This report was produced using data from private and government sources deemed to be reliable. The information herein is provided without representation or warranty.

# DEMOGRAPHIC PROFILE EXPANDED

1990 - 2000 Census, 2009 Estimates & 2014 Projections

Calculated using Proportional Block Groups

Prepared For



Lat/Lon: 33.379248/-111.688191

February 2010

RF5

## S Power Rd & E Baseline Rd Mesa, Arizona

	1.00 mi radius		3.00 mi radius		5.00 mi radius	
<b>Race &amp; Ethnicity</b>						
White (2009)	9,562	85.6%	81,286	87.1%	236,391	86.1%
Black or African American (2009)	356	3.2%	2,405	2.6%	7,680	2.8%
American Indian & Alaska Native (2009)	107	1.0%	927	1.0%	3,038	1.1%
Asian (2009)	319	2.9%	2,139	2.3%	6,633	2.4%
Hawaiian & Pacific Islander (2009)	42	0.4%	174	0.2%	614	0.2%
Other Race (2009)	441	3.9%	3,972	4.3%	12,803	4.7%
Two or More Races (2009)	344	3.1%	2,417	2.6%	7,307	2.7%
Not Hispanic or Latino Population (2009)	9,042	80.9%	75,834	81.3%	220,721	80.4%
Hispanic or Latino Population (2009)	2,130	19.1%	17,486	18.7%	53,745	19.6%
Not of Hispanic Origin Population (1990)	785	92.4%	29,385	93.8%	96,538	93.7%
Hispanic Origin Population (1990)	64	7.6%	1,930	6.2%	6,498	6.3%
Not Hispanic or Latino Population (2000)	8,863	90.1%	60,046	90.6%	171,100	89.9%
Hispanic or Latino Population (2000)	971	9.9%	6,206	9.4%	19,276	10.1%
Not Hispanic or Latino Population (2014)	9,117	78.3%	86,702	78.6%	247,302	77.7%
Hispanic or Latino Population (2014)	2,522	21.7%	23,637	21.4%	70,892	22.3%
Hist. Hispanic Ann Growth (1990 to 2009)	2,066	169.0%	15,555	42.4%	47,247	38.3%
Proj. Hispanic Ann Growth (2009 to 2014)	391	3.7%	6,151	7.0%	17,147	6.4%
<b>Age Distribution</b>						
Age 0 to 4 yrs (2009)	1,011	9.0%	6,876	7.4%	22,452	8.2%
Age 5 to 9 yrs (2009)	1,083	9.7%	6,787	7.3%	21,579	7.9%
Age 10 to 14 yrs (2009)	978	8.8%	6,169	6.6%	19,490	7.1%
Age 15 to 19 yrs (2009)	804	7.2%	5,196	5.6%	16,604	6.0%
Age 20 to 24 yrs (2009)	513	4.6%	4,064	4.4%	13,928	5.1%
Age 25 to 29 yrs (2009)	768	6.9%	5,387	5.8%	18,201	6.6%
Age 30 to 34 yrs (2009)	983	8.8%	6,272	6.7%	19,971	7.3%
Age 35 to 39 yrs (2009)	1,009	9.0%	6,151	6.6%	19,313	7.0%
Age 40 to 44 yrs (2009)	877	7.9%	5,596	6.0%	17,716	6.5%
Age 45 to 49 yrs (2009)	768	6.9%	4,936	5.3%	16,211	5.9%
Age 50 to 54 yrs (2009)	612	5.5%	4,600	4.9%	14,590	5.3%
Age 55 to 59 yrs (2009)	482	4.3%	4,403	4.7%	13,289	4.8%
Age 60 to 64 yrs (2009)	396	3.5%	4,810	5.2%	12,892	4.7%
Age 65 to 74 yrs (2009)	511	4.6%	9,988	10.7%	23,170	8.4%
Age 75 to 84 yrs (2009)	274	2.4%	8,612	9.2%	18,025	6.6%
Age 85 yrs plus (2009)	104	0.9%	3,474	3.7%	7,035	2.6%
Median Age (2009)	31.4 yrs		41.8 yrs		37.7 yrs	
<b>Gender Age Distribution</b>						
Female Population (2009)	5,586	50.0%	48,440	51.9%	140,524	51.2%
Age 0 to 19 yrs (2009)	1,919	34.3%	12,339	25.5%	39,343	28.0%
Age 20 to 64 yrs (2009)	3,182	57.0%	23,469	48.4%	73,823	52.5%
Age 65 yrs plus (2009)	486	8.7%	12,632	26.1%	27,359	19.5%
Female Median Age (2009)	31.8 yrs		43.5 yrs		39.2 yrs	
Male Population (2009)	5,586	50.0%	44,879	48.1%	133,942	48.8%
Age 0 to 19 yrs (2009)	1,957	35.0%	12,688	28.3%	40,781	30.4%
Age 20 to 64 yrs (2009)	3,227	57.8%	22,749	50.7%	72,288	54.0%
Age 65 yrs plus (2009)	403	7.2%	9,442	21.0%	20,872	15.6%
Male Median Age (2009)	31.0 yrs		39.9 yrs		36.2 yrs	

This report was produced using data from private and government sources deemed to be reliable. The information herein is provided without representation or warranty.

# DEMOGRAPHIC PROFILE EXPANDED

1990 - 2000 Census, 2009 Estimates & 2014 Projections

Calculated using Proportional Block Groups

Prepared For



Lat/Lon: 33.379248/-111.688191

February 2010

RF5

S Power Rd & E Baseline Rd Mesa, Arizona	1.00 mi radius		3.00 mi radius		5.00 mi radius	
<b>Household Income Distribution</b>						
HH Income \$200,000 or More (2009)	112	3.3%	870	2.6%	2,558	2.7%
HH Income \$150,000 to \$199,999 (2009)	190	5.6%	1,192	3.5%	3,551	3.7%
HH Income \$100,000 to \$149,999 (2009)	767	22.6%	5,224	15.5%	15,153	16.0%
HH Income \$75,000 to \$99,999 (2009)	683	20.2%	5,331	15.9%	15,793	16.7%
HH Income \$50,000 to \$74,999 (2009)	847	25.0%	6,931	20.6%	19,998	21.1%
HH Income \$35,000 to \$49,999 (2009)	379	11.2%	5,234	15.6%	13,845	14.6%
HH Income \$25,000 to \$34,999 (2009)	150	4.4%	3,248	9.7%	8,664	9.1%
HH Income \$15,000 to \$24,999 (2009)	147	4.3%	3,329	9.9%	8,599	9.1%
HH Income \$0 to \$14,999 (2009)	116	3.4%	2,249	6.7%	6,639	7.0%
HH Income \$35,000+ (2009)	2,977	87.8%	24,782	73.7%	70,898	74.8%
HH Income \$75,000+ (2009)	1,752	51.7%	12,617	37.5%	37,055	39.1%
<b>Housing</b>						
Total Housing Units (2009)	3,812		44,765		126,610	
Housing Units, Occupied (2009)	3,391	88.9%	33,608	75.1%	94,799	74.9%
<i>Housing Units, Owner-Occupied (2009)</i>	2,570	75.8%	27,391	81.5%	76,034	80.2%
<i>Housing Units, Renter-Occupied (2009)</i>	821	24.2%	6,217	18.5%	18,765	19.8%
Housing Units, Vacant (2009)	422	11.1%	11,157	24.9%	31,811	25.1%
Median Years in Residence (2009)	2.5	<i>yrs</i>	3.1	<i>yrs</i>	3.0	<i>yrs</i>
<b>Marital Status</b>						
Never Married (2009)	1,622	20.1%	11,022	15.0%	36,069	17.1%
Now Married (2009)	5,419	67.1%	47,499	64.6%	134,084	63.7%
Separated (2009)	164	2.0%	2,118	2.9%	5,765	2.7%
Widowed (2009)	176	2.2%	7,035	9.6%	15,512	7.4%
Divorced (2009)	697	8.6%	5,844	7.9%	19,221	9.1%
<b>Household Type</b>						
Population Family (2009)	10,134	90.7%	79,489	85.2%	237,224	86.4%
Population Non-Family (2009)	1,029	9.2%	12,476	13.4%	35,270	12.9%
Population Group Qtrs (2009)	9	0.1%	1,354	1.5%	1,972	0.7%
Family Households (2009)	2,576	76.0%	22,836	67.9%	65,761	69.4%
Married Couple With Children (2009)	1,230	22.7%	7,631	16.1%	24,029	17.9%
Average Family Household Size (2009)	3.93		3.48		3.61	
Non-Family Households (2009)	815	24.0%	10,772	32.1%	29,037	30.6%
<b>Household Size</b>						
1 Person Household (2009)	620	18.3%	9,288	27.6%	24,237	25.6%
2 Person Households (2009)	712	21.0%	9,298	27.7%	24,221	25.5%
3 Person Households (2009)	392	11.6%	3,023	9.0%	9,552	10.1%
4 Person Households (2009)	912	26.9%	6,234	18.5%	19,429	20.5%
5 Person Households (2009)	451	13.3%	3,237	9.6%	9,916	10.5%
6+ Person Households (2009)	303	8.9%	2,528	7.5%	7,444	7.9%
<b>Household Vehicles</b>						
Total Vehicles Available (2009)	6,537		57,906		170,720	
Household: 0 Vehicles Available (2009)	97	2.9%	1,537	4.6%	4,032	4.3%
Household: 1 Vehicles Available (2009)	1,011	29.8%	13,576	40.4%	34,750	36.7%
Household: 2+ Vehicles Available (2009)	2,283	67.3%	18,495	55.0%	56,017	59.1%
Average Vehicles Per Household (2009)	1.9		1.7		1.8	

This report was produced using data from private and government sources deemed to be reliable. The information herein is provided without representation or warranty.

# DEMOGRAPHIC PROFILE EXPANDED

1990 - 2000 Census, 2009 Estimates & 2014 Projections

Calculated using Proportional Block Groups

Prepared For



Lat/Lon: 33.379248/-111.688191

February 2010

RF5

## S Power Rd & E Baseline Rd Mesa, Arizona

	1.00 mi radius		3.00 mi radius		5.00 mi radius	
<b>Labor Force</b>						
Est. Labor: Population Age 16+ (2009)	7,889		72,379		207,035	
Est. Civilian Employed (2009)	5,343	67.7%	38,484	53.2%	120,543	58.2%
Est. Civilian Unemployed (2009)	228	2.9%	2,318	3.2%	7,409	3.6%
Est. in Armed Forces (2009)	10	0.1%	71	0.1%	198	0.1%
Est. not in Labor Force (2009)	2,308	29.3%	31,506	43.5%	78,884	38.1%
<b>Occupation</b>						
Occupation: Population Age 16+ (2000)	4,783		24,667		79,179	
Mgmt, Business, & Financial Operations (200)	690	14.4%	3,444	14.0%	11,625	14.7%
Professional and Related (2000)	1,051	22.0%	4,889	19.8%	15,570	19.7%
Service (2000)	536	11.2%	2,929	11.9%	10,075	12.7%
Sales and Office (2000)	1,632	34.1%	8,164	33.1%	25,051	31.6%
Farming, Fishing, and Forestry (2000)	0		93	0.4%	182	0.2%
Construct, Extraction, & Maintenance (2000)	416	8.7%	2,581	10.5%	8,078	10.2%
Production, Transp. & Material Moving (2000)	460	9.6%	2,566	10.4%	8,597	10.9%
Percent White Collar Workers (2000)	70.5%		66.9%		66.0%	
Percent Blue Collar Workers (2000)	29.5%		33.1%		34.0%	
<b>Consumer Expenditure (in \$,000,000s)</b>						
Total Household Expenditure (2009)	\$202		\$1,743		\$4,964	
Total Non-Retail Expenditures (2009)	\$117	58.0%	\$1,005	57.7%	\$2,866	57.7%
Total Retail Expenditures (2009)	\$85	42.0%	\$738	42.3%	\$2,099	42.3%
Apparel (2009)	\$10	4.8%	\$83	4.8%	\$238	4.8%
Contributions (2009)	\$7	3.7%	\$64	3.7%	\$182	3.7%
Education (2009)	\$5	2.5%	\$41	2.4%	\$119	2.4%
Entertainment (2009)	\$11	5.6%	\$98	5.6%	\$279	5.6%
Food And Beverages (2009)	\$31	15.1%	\$267	15.3%	\$759	15.3%
Furnishings And Equipment (2009)	\$9	4.6%	\$77	4.4%	\$221	4.5%
Gifts (2009)	\$5	2.7%	\$45	2.6%	\$129	2.6%
Health Care (2009)	\$12	5.8%	\$106	6.1%	\$299	6.0%
Household Operations (2009)	\$8	3.7%	\$63	3.6%	\$180	3.6%
Miscellaneous Expenses (2009)	\$3	1.6%	\$29	1.7%	\$82	1.7%
Personal Care (2009)	\$3	1.4%	\$25	1.4%	\$72	1.4%
Personal Insurance (2009)	\$2	1.0%	\$18	1.0%	\$51	1.0%
Reading (2009)	\$1	0.3%	\$6	0.3%	\$16	0.3%
Shelter (2009)	\$39	19.3%	\$336	19.3%	\$958	19.3%
Tobacco (2009)	\$1	0.6%	\$11	0.6%	\$32	0.6%
Transportation (2009)	\$41	20.3%	\$352	20.2%	\$1,004	20.2%
Utilities (2009)	\$14	6.8%	\$121	6.9%	\$344	6.9%
<b>Educational Attainment</b>						
Adult Population (25 Years or Older) (2009)	6,783		64,227		180,414	
Elementary (0 to 8) (2009)	245	3.6%	3,027	4.7%	7,925	4.4%
Some High School (9 to 11) (2009)	275	4.1%	4,342	6.8%	12,465	6.9%
High School Graduate (12) (2009)	1,698	25.0%	19,232	29.9%	52,815	29.3%
Some College (13 to 16) (2009)	1,847	27.2%	15,827	24.6%	45,448	25.2%
Associate Degree Only (2009)	672	9.9%	5,283	8.2%	16,934	9.4%
Bachelor Degree Only (2009)	1,399	20.6%	11,246	17.5%	30,479	16.9%
Graduate Degree (2009)	648	9.5%	5,270	8.2%	14,346	8.0%

This report was produced using data from private and government sources deemed to be reliable. The information herein is provided without representation or warranty.

# DEMOGRAPHIC PROFILE EXPANDED

1990 - 2000 Census, 2009 Estimates & 2014 Projections

Calculated using Proportional Block Groups

Prepared For



Lat/Lon: 33.379248/-111.688191

February 2010

RF5

## S Power Rd & E Baseline Rd Mesa, Arizona

	1.00 mi radius		3.00 mi radius		5.00 mi radius	
<b>Units In Structure</b>						
1 Detached Unit (2000)	2,608	76.2%	19,788	56.3%	50,908	53.5%
1 Attached Unit (2000)	116	3.4%	2,467	7.0%	4,969	5.2%
2 to 4 Units (2000)	168	4.9%	909	2.6%	2,679	2.8%
5 to 9 Units (2000)	237	6.9%	963	2.7%	2,109	2.2%
10 to 19 Units (2000)	18	0.5%	778	2.2%	2,425	2.5%
20 to 49 Units (2000)	24	0.7%	292	0.8%	816	0.9%
50 or more Units (2000)	48	1.4%	1,064	3.0%	2,700	2.8%
Mobile Home or Trailer (2000)	202	5.9%	8,714	24.8%	26,820	28.2%
Other Structure (2000)	0		155	0.4%	1,804	1.9%
<b>Homes Built By Year</b>						
Homes Built 1999 to 2000	113	3.3%	2,086	5.9%	6,387	6.7%
Homes Built 1995 to 1998	1,873	54.8%	9,571	27.2%	20,697	21.7%
Homes Built 1990 to 1994	982	28.7%	5,072	14.4%	14,018	14.7%
Homes Built 1980 to 1989	251	7.3%	9,822	28.0%	31,281	32.8%
Homes Built 1970 to 1979	158	4.6%	6,627	18.9%	16,582	17.4%
Homes Built 1960 to 1969	30	0.9%	1,199	3.4%	4,292	4.5%
Homes Built 1950 to 1959	6	0.2%	455	1.3%	1,275	1.3%
Homes Built Before 1949	7	0.2%	298	0.8%	697	0.7%
<b>Home Values</b>						
Home Values \$1,000,000 or More (2000)	0		0		16	0.0%
Home Values \$500,000 to \$999,999 (2000)	7	0.3%	52	0.3%	164	0.4%
Home Values \$400,000 to \$499,999 (2000)	17	0.7%	71	0.4%	229	0.5%
Home Values \$300,000 to \$399,999 (2000)	39	1.6%	315	1.8%	1,186	2.6%
Home Values \$200,000 to \$299,999 (2000)	226	9.5%	1,583	8.9%	4,273	9.3%
Home Values \$150,000 to \$199,999 (2000)	755	31.6%	3,950	22.2%	8,907	19.4%
Home Values \$100,000 to \$149,999 (2000)	1,266	53.0%	8,268	46.4%	21,463	46.6%
Home Values \$70,000 to \$99,999 (2000)	70	2.9%	2,894	16.2%	8,183	17.8%
Home Values \$50,000 to \$69,999 (2000)	0		463	2.6%	1,134	2.5%
Home Values \$25,000 to \$49,999 (2000)	1	0.0%	113	0.6%	274	0.6%
Home Values \$0 to \$24,999 (2000)	8	0.3%	115	0.6%	189	0.4%
Owner Occupied Median Home Value (2000)	\$146,845		\$135,225		\$134,992	
Renter Occupied Median Rent (2000)	\$852		\$764		\$688	
<b>Transportation To Work</b>						
Drive to Work Alone (2000)	3,922	81.8%	19,854	80.3%	63,347	79.9%
Drive to Work in Carpool (2000)	447	9.3%	2,840	11.5%	10,169	12.8%
Travel to Work - Public Transportation (2000)	59	1.2%	186	0.8%	459	0.6%
Drive to Work on Motorcycle (2000)	14	0.3%	86	0.3%	377	0.5%
Walk or Bicycle to Work (2000)	90	1.9%	599	2.4%	1,562	2.0%
Other Means (2000)	34	0.7%	160	0.6%	512	0.6%
Work at Home (2000)	229	4.8%	996	4.0%	2,902	3.7%
<b>Travel Time</b>						
Travel to Work in 14 Minutes or Less (2000)	993	21.8%	5,123	21.6%	16,175	21.2%
Travel to Work in 14 to 29 Minutes (2000)	1,463	32.0%	7,564	31.9%	24,468	32.0%
Travel to Work in 30 to 59 Minutes (2000)	1,696	37.2%	8,963	37.8%	29,599	38.7%
Travel to Work in 60 Minutes or More (2000)	413	9.0%	2,074	8.7%	6,183	8.1%
Average Travel Time to Work (2000)	27.6	mins	27.1	mins	27.3	mins

This report was produced using data from private and government sources deemed to be reliable. The information herein is provided without representation or warranty.