

SANTAN PLAZA

SOUTHWEST CORNER OF AZ AVE. & LOOP 202, CHANDLER, AZ

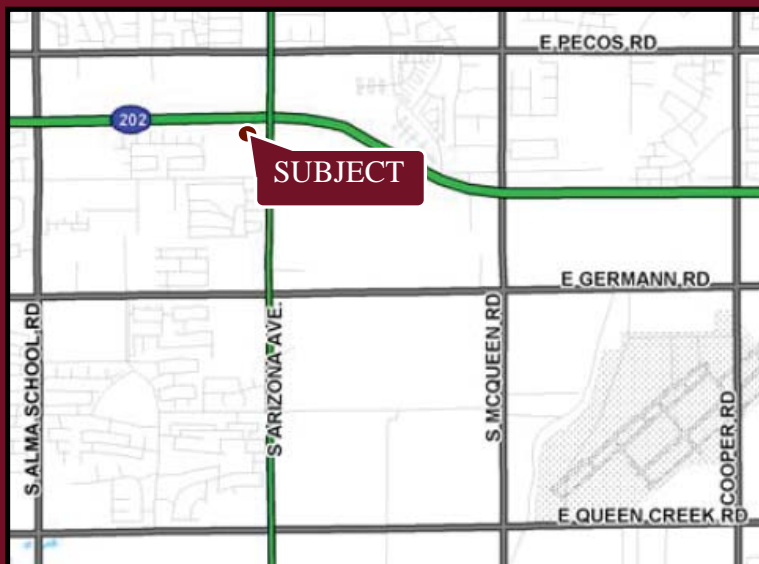
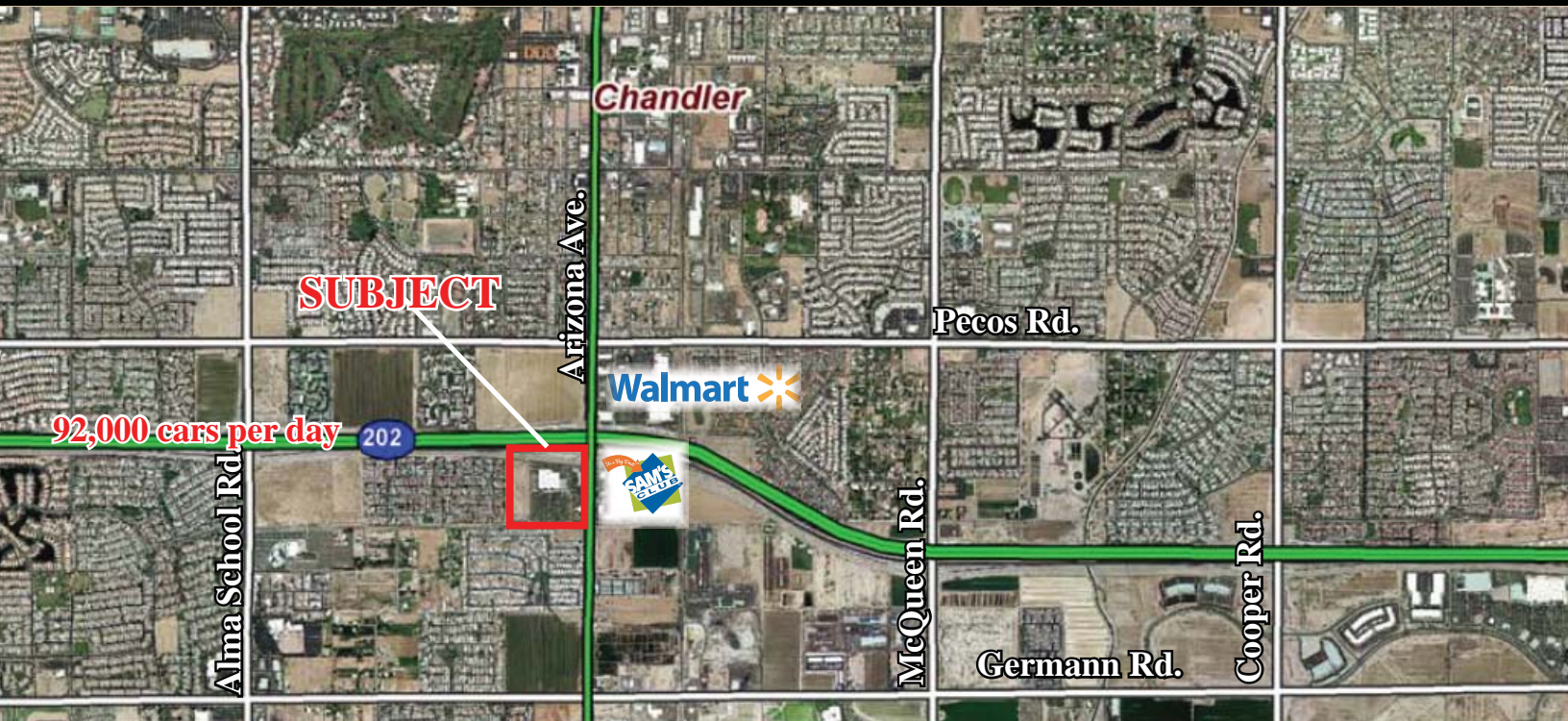

FEATURES

- Kohl's anchored power center
- Dense infill population
- Major arterial traffic-Loop 202 & SR 87 (Arizona Ave.)
- Major destination intersection in SE Valley
- Freeway pylon signage available

NOTABLE TENANTS



2010 Demographics	1 MILE	3 MILE	5 MILE
Estimated Population	14,613	127,220	287,343
Avg. Household Income	\$68,290	\$79,959	\$84,761
Estimated Households	6,375	35,566	86,061

Information contained herein is believed to be accurate but is not warranted as to accuracy and may change or be updated without notice. Seller or landlord makes no representation as to the environmental condition of the property and recommends purchaser's or tenant's independent investigation.

EXCLUSIVELY REPRESENTED BY

WWW.STRATEGICRETAILGROUP.COM



JASON FESSINGER
602.778.3833
jasonf@srgaz.com

MATT MILINOVICH
602.778.3830
mattm@srgaz.com

15169 N. Scottsdale Road Suite 330 Scottsdale, AZ 85254 602.778.3838(p) 602.778.3839(f)

SAN TAN PLAZA

SOUTHWEST CORNER OF AZ AVE. & LOOP 202, CHANDLER, AZ



Loop 202 Freeway Monument Signage

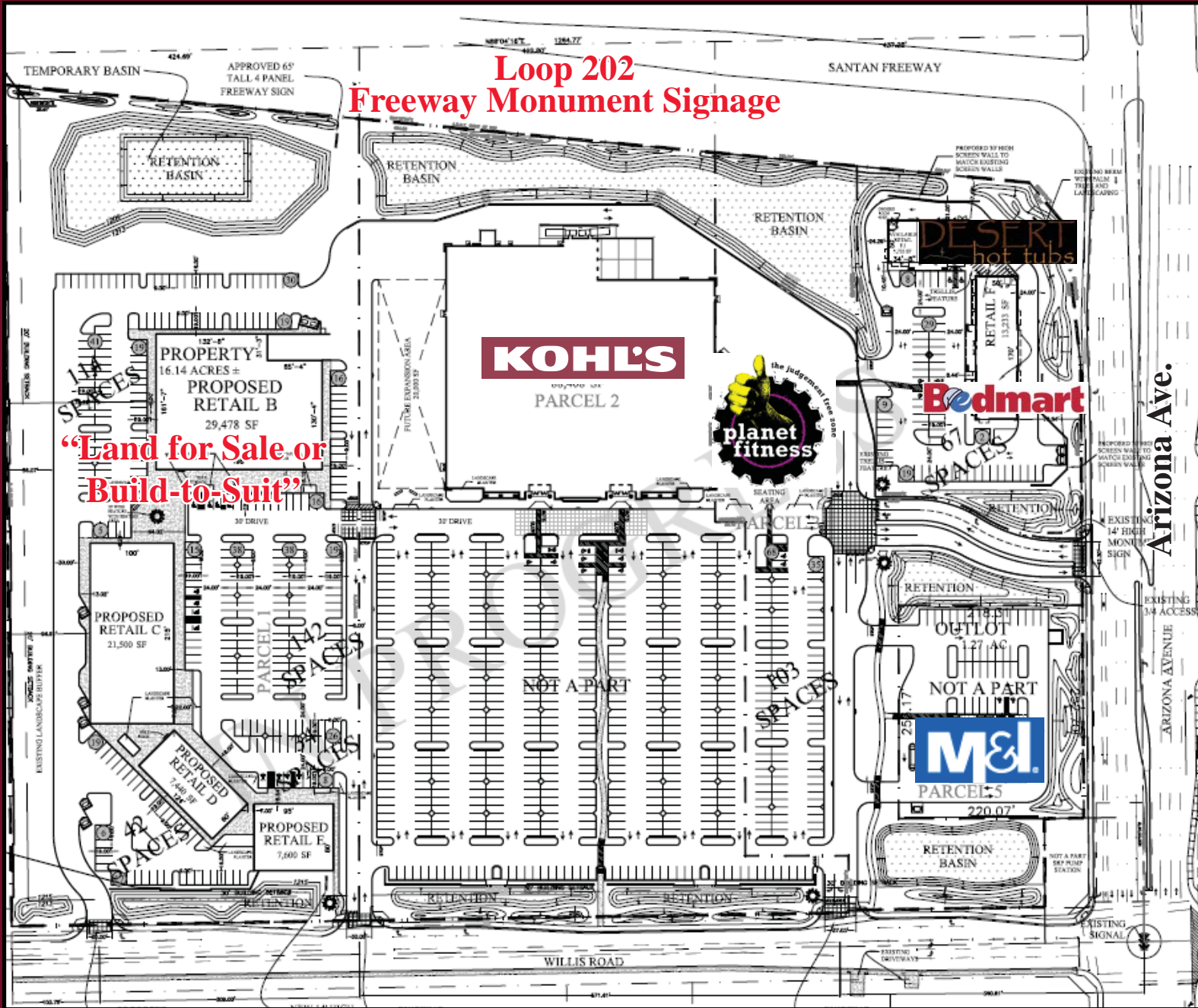

STRATEGIC
RETAIL GROUP

EXCLUSIVELY REPRESENTED BY

JASON FESSINGER
602.778.3833
jasonf@srgaz.com

WWW.STRATEGICRETAILGROUP.COM

MATT MILINOVICH
602.778.3830
mattm@srgaz.com

15169 N. Scottsdale Road Suite 330 Scottsdale, AZ 85254 602.778.3838(p) 602.778.3839(f)



EXPANDED PROFILE

1990 - 2000 Census, 2010 Estimates with 2015 Projections
 Calculated using Proportional Block Groups

Lat/Lon: 33.28796/-111.8416

Az Ave. & Loop 202

Chandler, AZ

	1 Mile	3 Miles	5 Miles
Population (2010)			
Estimated Population	14,613	127,220	287,343
Census Population (1990)	5,014	38,280	95,495
Census Population (2000)	9,214	86,622	193,348
Projected Population (2015)	15,899	149,171	331,907
Forecasted Population (2020)	19,609	183,894	408,834
Historical Annual Growth (1990 to 2000)	4,200 8.38%	48,343 12.63%	97,854 10.25%
Historical Annual Growth (2000 to 2010)	5,399 5.86%	40,598 4.69%	93,994 4.86%
Projected Annual Growth (2010 to 2015)	1,285 1.76%	21,951 3.45%	44,564 3.10%
Estimated Population Density	4,655 <i>psm</i>	4,501 <i>psm</i>	3,661 <i>psm</i>
Trade Area Size	3.14 <i>sq mil</i>	28.26 <i>sq mil</i>	78.49 <i>sq mil</i>
Households (2010)			
Estimated Households	4,347	39,922	92,568
Census Households (1990)	1,687	13,090	32,509
Census Households (2000)	2,765	28,779	66,971
Projected Households (2015)	4,692	46,703	106,131
Forecasted Households (2020)	5,760	56,641	127,839
Households with Children	1,990 45.78%	17,425 43.65%	38,839 41.96%
Average Household Size	3.36	3.17	3.09
Average Household Income (2010)			
Est. Average Household Income	\$68,290	\$79,959	\$84,761
Proj. Average Household Income (2015)	\$75,887	\$89,752	\$92,941
Average Family Income	\$72,771	\$88,046	\$93,416
Median Household Income (2010)			
Est. Median Household Income	\$52,434	\$67,638	\$73,533
Proj. Median Household Income (2015)	\$54,982	\$73,545	\$78,051
Median Family Income	\$57,134	\$74,404	\$81,253
Per Capita Income (2010)			
Est. Per Capita Income	\$20,380	\$25,448	\$27,485
Proj. Per Capita Income (2015)	\$22,456	\$28,417	\$29,880
Per Capita Income Est. 5 year change	\$2,076 10.19%	\$2,969 11.67%	\$2,396 8.72%
Other Income (2010)			
Est. Median Disposable Income	\$44,026	\$54,971	\$59,210
Proj. Median Disposable Income (2015)	\$46,053	\$59,072	\$62,347
Disposable Income Est. 5 year change	\$2,028 4.61%	\$4,101 7.46%	\$3,138 5.30%
Est. Average Household Net Worth	\$414,052	\$515,062	\$563,724
Daytime Demos (2010)			
Total Number of Businesses	310	2,747	7,015
Total Number of Employees	6,375	35,566	86,061
Company Headqtrs: Businesses	- -	1 0.04%	5 0.07%
Company Headqtrs: Employees	- -	507 1.42%	1,495 1.74%
Unemployment Rate	5.36%	4.49%	4.36%
Employee Population per Business	20.6 to 1	12.9 to 1	12.3 to 1
Residential Population per Business	47.2 to 1	46.3 to 1	41.0 to 1

This report was produced using data from private and government sources deemed to be reliable. The information herein is provided without representation or warranty.

EXPANDED PROFILE

1990 - 2000 Census, 2010 Estimates with 2015 Projections
 Calculated using Proportional Block Groups

Lat/Lon: 33.28796/-111.8416

Az Ave. & Loop 202

Chandler, AZ

Race & Ethnicity (2010)

	1 Mile		3 Miles		5 Miles	
White	12,240	83.76%	108,857	85.57%	250,538	87.19%
Black or African American	915	6.26%	6,594	5.18%	12,745	4.44%
American Indian & Alaska Native	429	2.94%	2,382	1.87%	4,522	1.57%
Asian	514	3.52%	6,253	4.92%	14,085	4.90%
Hawaiian & Pacific Islander	45	0.31%	306	0.24%	610	0.21%
Other Race	404	2.77%	2,275	1.79%	3,618	1.26%
Two or More Races	66	0.45%	553	0.43%	1,223	0.43%
Not Hispanic or Latino Population	7,716	52.80%	83,276	65.46%	206,012	71.70%
Hispanic or Latino Population	6,897	47.20%	43,944	34.54%	81,331	28.30%
Not of Hispanic Origin Population (1990)	2,399	47.86%	27,461	71.74%	78,915	82.64%
Hispanic Origin Population (1990)	2,614	52.14%	10,819	28.26%	16,580	17.36%
Not Hispanic or Latino Population (2000)	4,151	45.06%	61,024	70.45%	154,517	79.92%
Hispanic or Latino Population (2000)	5,062	54.94%	25,599	29.55%	38,832	20.08%
Not Hispanic or Latino Population (2015)	8,132	51.15%	95,941	64.32%	229,857	69.25%
Hispanic or Latino Population (2015)	7,767	48.85%	53,230	35.68%	102,050	30.75%
Hist. Hispanic Ann Growth (1990 to 2010)	4,283	8.19%	33,126	15.31%	64,751	19.53%
Proj. Hispanic Ann Growth (2015 to 2010)	869	2.52%	9,286	4.23%	20,719	5.10%

Age Distribution (2010)

0 to 4 yrs	1,551	10.61%	12,377	9.73%	25,290	8.80%
5 to 9 yrs	1,361	9.32%	11,358	8.93%	24,665	8.58%
10 to 14 yrs	1,092	7.47%	9,718	7.64%	22,657	7.89%
15 to 19 yrs	953	6.52%	8,321	6.54%	19,559	6.81%
20 to 24 yrs	977	6.69%	7,572	5.95%	15,850	5.52%
25 to 29 yrs	1,375	9.41%	10,424	8.19%	21,449	7.46%
30 to 34 yrs	1,372	9.39%	11,870	9.33%	24,681	8.59%
35 to 39 yrs	1,148	7.86%	10,936	8.60%	24,730	8.61%
40 to 44 yrs	982	6.72%	9,411	7.40%	22,510	7.83%
45 to 49 yrs	831	5.69%	8,269	6.50%	20,050	6.98%
50 to 54 yrs	777	5.32%	7,110	5.59%	17,718	6.17%
55 to 59 yrs	629	4.30%	5,763	4.53%	14,295	4.97%
60 to 64 yrs	458	3.14%	4,488	3.53%	11,276	3.92%
65 to 74 yrs	600	4.11%	5,237	4.12%	13,173	4.58%
75 to 84 yrs	326	2.23%	2,790	2.19%	6,278	2.18%
85 yrs plus	180	1.23%	1,574	1.24%	3,162	1.10%
Median Age	29.14 yrs		30.72 yrs		32.29 yrs	

Gender Age Distribution (2010)

Female Population	7,018	48.03%	62,797	49.36%	142,223	49.50%
0 to 19 yrs	2,371	33.79%	20,401	32.49%	44,933	31.59%
20 to 64 yrs	4,052	57.73%	37,044	58.99%	84,996	59.76%
65 yrs plus	595	8.48%	5,352	8.52%	12,294	8.64%
Female Median Age	29 yrs		31 yrs		33 yrs	
Male Population	7,595	51.97%	64,423	50.64%	145,120	50.50%
0 to 19 yrs	2,586	34.05%	21,374	33.18%	47,239	32.55%
20 to 64 yrs	4,498	59.22%	38,800	60.23%	87,562	60.34%
65 yrs plus	511	6.73%	4,250	6.60%	10,320	7.11%
Male Median Age	28.96 yrs		30.33 yrs		31.82 yrs	

This report was produced using data from private and government sources deemed to be reliable. The information herein is provided without representation or warranty.

EXPANDED PROFILE

1990 - 2000 Census, 2010 Estimates with 2015 Projections
 Calculated using Proportional Block Groups

Lat/Lon: 33.28796/-111.8416

Az Ave. & Loop 202

Chandler, AZ

	1 Mile		3 Miles		5 Miles	
Household Income Distribution (2010)						
\$200,000 or More	61	1.41%	1,058	2.65%	2,765	2.99%
\$150,000 to \$199,999	120	2.76%	1,833	4.59%	5,257	5.68%
\$100,000 to \$149,999	507	11.67%	6,856	17.17%	18,789	20.30%
\$75,000 to \$99,999	542	12.46%	7,124	17.85%	17,643	19.06%
\$50,000 to \$74,999	1,233	28.36%	10,017	25.09%	21,605	23.34%
\$35,000 to \$49,999	675	15.54%	5,009	12.55%	11,158	12.05%
\$25,000 to \$34,999	396	9.11%	3,033	7.60%	6,141	6.63%
\$15,000 to \$24,999	407	9.36%	2,619	6.56%	4,826	5.21%
\$0 to \$14,999	406	9.34%	2,372	5.94%	4,384	4.74%
\$35,000+	3,138	72.19%	31,897	79.90%	77,217	83.42%
\$75,000+	1,230	28.30%	16,871	42.26%	44,455	48.02%
Housing (2010)						
Total Housing Units	4,803		44,127		101,810	
Housing Units, Occupied	4,347	90.52%	39,922	90.47%	92,568	90.92%
<i>Housing Units, Owner-Occupied</i>	2,566	59.02%	28,207	70.66%	69,290	74.85%
<i>Housing Units, Renter-Occupied</i>	1,781	40.98%	11,714	29.34%	23,278	25.15%
Housing Units, Vacant	455	9.48%	4,205	9.53%	9,242	9.08%
Median Years in Residence	2 yrs		2 yrs		3 yrs	
Marital Status (2010)						
Never Married	2,412	22.85%	22,189	23.76%	50,037	23.35%
Now Married	6,398	60.61%	55,866	59.81%	131,548	61.39%
Separated	663	6.28%	3,895	4.17%	6,658	3.11%
Widowed	391	3.71%	3,307	3.54%	6,987	3.26%
Divorced	692	6.56%	8,147	8.72%	19,046	8.89%
Household Type (2010)						
Population Family	12,648	86.56%	110,807	87.10%	252,206	87.77%
Population Non-Family	1,960	13.41%	15,735	12.37%	34,257	11.92%
Population Group Qtrs	5	0.03%	678	0.53%	879	0.31%
Family Households	3,110	71.53%	28,600	71.64%	66,660	72.01%
<i>Married Couple With Children</i>	1,365	21.34%	12,395	22.19%	28,424	21.61%
<i>Average Family Household Size</i>	4.1		3.9		3.8	
Non-Family Households	1,238	28.47%	11,322	28.36%	25,908	27.99%
Household Size (2010)						
1 Person Household	949	21.83%	8,645	21.65%	19,816	21.41%
2 Person Households	841	19.35%	8,801	22.05%	21,878	23.63%
3 Person Households	554	12.75%	5,191	13.00%	11,925	12.88%
4 Person Households	970	22.31%	9,125	22.86%	21,200	22.90%
5 Person Households	544	12.52%	4,601	11.52%	10,305	11.13%
6+ Person Households	489	11.25%	3,559	8.91%	7,445	8.04%
Household Vehicles (2010)						
Total Vehicles Available	7,502		74,003		178,934	
Household: 0 Vehicles Available	314	7.21%	1,914	4.79%	3,222	3.48%
Household: 1 Vehicles Available	1,655	38.07%	12,712	31.84%	28,551	30.84%
Household: 2+ Vehicles Available	2,379	54.72%	25,296	63.36%	60,794	65.68%
Average Vehicles Per Household	1.7		1.9		1.9	

This report was produced using data from private and government sources deemed to be reliable. The information herein is provided without representation or warranty.

EXPANDED PROFILE

1990 - 2000 Census, 2010 Estimates with 2015 Projections
 Calculated using Proportional Block Groups

Lat/Lon: 33.28796/-111.8416

Az Ave. & Loop 202

Chandler, AZ

	1 Mile		3 Miles		5 Miles	
Labor Force (2010)						
Est. Labor: Population Age 16+	10,373		91,635		209,972	
Est. Civilian Employed	6,796	65.51%	61,882	67.53%	142,095	67.67%
Est. Civilian Unemployed	556	5.36%	4,117	4.49%	9,154	4.36%
Est. in Armed Forces	4	0.04%	81	0.09%	161	0.08%
Est. not in Labor Force	3,018	29.10%	25,555	27.89%	58,562	27.89%
Occupation (2000)						
Occupation: Population Age 16+	4,223		42,835		100,285	
Mgmt, Business, & Financial Operations	385	9.11%	6,472	15.11%	17,498	17.45%
Professional and Related	678	16.06%	9,293	21.69%	23,814	23.75%
Service	787	18.63%	5,458	12.74%	11,605	11.57%
Sales and Office	976	23.10%	11,806	27.56%	28,868	28.79%
Farming, Fishing, and Forestry	102	2.41%	363	0.85%	510	0.51%
Construct, Extraction, & Maintenance	513	12.15%	4,161	9.71%	7,886	7.86%
Production, Transp. & Material Moving	783	18.54%	5,281	12.33%	10,103	10.07%
<i>Percent White Collar Workers</i>	48.27%		64.37%		69.98%	
<i>Percent Blue Collar Workers</i>	51.73%		35.63%		30.02%	
Consumer Expenditure (2010)						
Total Household Expenditure	\$235 M		\$2.41 B		\$5.83 B	
<i>Total Non-Retail Expenditures</i>	\$135 M	57.69%	\$1.39 B	57.88%	\$3.38 B	57.92%
<i>Total Retail Expenditures</i>	\$99.4 M	42.31%	\$1.01 B	42.12%	\$2.45 B	42.08%
Apparel	\$11.4 M	4.84%	\$116 M	4.82%	\$280 M	4.81%
Contributions	\$8.11 M	3.45%	\$88.0 M	3.65%	\$217 M	3.73%
Education	\$5.42 M	2.31%	\$58.8 M	2.44%	\$145 M	2.50%
Entertainment	\$13.1 M	5.58%	\$135 M	5.62%	\$329 M	5.64%
Food And Beverages	\$36.6 M	15.56%	\$367 M	15.25%	\$882 M	15.14%
Furnishings And Equipment	\$10.2 M	4.34%	\$108 M	4.49%	\$264 M	4.53%
Gifts	\$5.86 M	2.50%	\$63.0 M	2.62%	\$156 M	2.67%
Health Care	\$14.3 M	6.09%	\$142 M	5.92%	\$342 M	5.86%
Household Operations	\$8.27 M	3.52%	\$88.0 M	3.66%	\$216 M	3.70%
Miscellaneous Expenses	\$3.92 M	1.67%	\$39.6 M	1.64%	\$95.6 M	1.64%
Personal Care	\$3.43 M	1.46%	\$34.9 M	1.45%	\$84.3 M	1.45%
Personal Insurance	\$2.33 M	0.99%	\$24.8 M	1.03%	\$61.0 M	1.05%
Reading	\$761 K	0.32%	\$7.83 M	0.33%	\$19.0 M	0.33%
Shelter	\$45.0 M	19.17%	\$464 M	19.27%	\$1.13 B	19.32%
Tobacco	\$1.58 M	0.67%	\$15.0 M	0.62%	\$35.2 M	0.60%
Transportation	\$47.9 M	20.38%	\$489 M	20.29%	\$1.18 B	20.23%
Utilities	\$16.8 M	7.14%	\$166 M	6.89%	\$396 M	6.80%
Educational Attainment (2010)						
Adult Population (25 Years or Older)	8,678		77,874		179,322	
Elementary (0 to 8)	1,473	16.97%	6,913	8.88%	10,438	5.82%
Some High School (9 to 11)	888	10.23%	5,645	7.25%	9,821	5.48%
High School Graduate (12)	1,915	22.07%	16,228	20.84%	36,367	20.28%
Some College (13 to 16)	1,786	20.58%	18,631	23.92%	44,508	24.82%
Associate Degree Only	728	8.39%	6,831	8.77%	16,365	9.13%
Bachelor Degree Only	1,330	15.33%	15,655	20.10%	40,669	22.68%
Graduate Degree	559	6.44%	7,971	10.24%	21,154	11.80%

This report was produced using data from private and government sources deemed to be reliable. The information herein is provided without representation or warranty.

EXPANDED PROFILE

1990 - 2000 Census, 2010 Estimates with 2015 Projections
 Calculated using Proportional Block Groups

Lat/Lon: 33.28796/-111.8416

Az Ave. & Loop 202

Chandler, AZ

	1 Mile		3 Miles		5 Miles	
Units In Structure (2000)						
1 Detached Unit	1,525	52.79%	20,871	67.99%	52,426	73.91%
1 Attached Unit	153	5.30%	1,433	4.67%	3,757	5.30%
2 to 4 Units	233	8.06%	1,463	4.77%	2,287	3.22%
5 to 9 Units	130	4.50%	1,700	5.54%	3,434	4.84%
10 to 19 Units	121	4.19%	1,600	5.21%	3,000	4.23%
20 to 49 Units	46	1.58%	606	1.97%	861	1.21%
50 or more Units	231	8.00%	1,389	4.52%	3,001	4.23%
Mobile Home or Trailer	450	15.59%	1,561	5.09%	2,075	2.92%
Other Structure	-	-	73	0.24%	95	0.13%
Homes Built By Year						
1999 to 2000	99	3.43%	3,351	10.92%	6,155	8.68%
1995 to 1998	800	27.69%	9,349	30.46%	19,930	28.10%
1990 to 1994	352	12.18%	4,631	15.09%	12,759	17.99%
1980 to 1989	733	25.38%	6,280	20.46%	21,156	29.82%
1970 to 1979	335	11.59%	3,609	11.76%	6,758	9.53%
1960 to 1969	219	7.57%	1,665	5.42%	2,042	2.88%
1950 to 1959	156	5.38%	1,073	3.49%	1,240	1.75%
Built Before 1949	196	6.78%	739	2.41%	896	1.26%
Home Values (2000)						
\$1,000,000 or More	-	-	13	0.07%	36	0.08%
\$500,000 to \$999,999	2	0.18%	91	0.48%	270	0.57%
\$400,000 to \$499,999	2	0.16%	106	0.56%	362	0.76%
\$300,000 to \$399,999	2	0.12%	297	1.58%	1,378	2.88%
\$200,000 to \$299,999	94	7.43%	3,049	16.24%	8,312	17.40%
\$150,000 to \$199,999	155	12.22%	4,018	21.41%	11,006	23.04%
\$100,000 to \$149,999	628	49.52%	8,138	43.35%	20,675	43.28%
\$70,000 to \$99,999	194	15.31%	2,444	13.02%	4,728	9.90%
\$50,000 to \$69,999	98	7.71%	440	2.35%	721	1.51%
\$25,000 to \$49,999	93	7.34%	135	0.72%	205	0.43%
\$0 to \$24,999	-	-	41	0.22%	76	0.16%
Owner Occupied Median Home Value	\$118,573		\$146,949		\$153,851	
Renter Occupied Median Rent	\$358		\$623		\$690	
Average Property Value (2010)	\$208,826		\$193,755		\$192,596	
Transportation To Work (2000)						
Drive to Work Alone	2,796	66.21%	32,909	76.71%	80,639	80.32%
Drive to Work in Carpool	1,100	26.05%	6,668	15.54%	12,790	12.74%
Travel to Work - Public Transportation	38	0.89%	417	0.97%	668	0.67%
Drive to Work on Motorcycle	7	0.16%	197	0.46%	455	0.45%
Walk or Bicycle to Work	204	4.82%	1,113	2.59%	1,847	1.84%
Other Means	21	0.49%	307	0.72%	548	0.55%
Work at Home	58	1.38%	1,290	3.01%	3,446	3.43%
Travel Time (2000)						
Travel to Work in 14 Minutes or Less	879	21.10%	8,904	21.40%	20,031	20.66%
Travel to Work in 14 to 29 Minutes	1,646	39.51%	15,620	37.54%	38,161	39.36%
Travel to Work in 30 to 59 Minutes	1,323	31.75%	14,784	35.53%	33,904	34.97%
Travel to Work in 60 Minutes or More	318	7.63%	2,304	5.54%	4,852	5.00%
Average Travel Time to Work	26.5 mins		25.0 mins		24.6 mins	

This report was produced using data from private and government sources deemed to be reliable. The information herein is provided without representation or warranty.