

VAL VISTA TOWNE CENTER

SOUTHWEST CORNER OF VAL VISTA DRIVE & WARNER ROAD, GILBERT, AZ

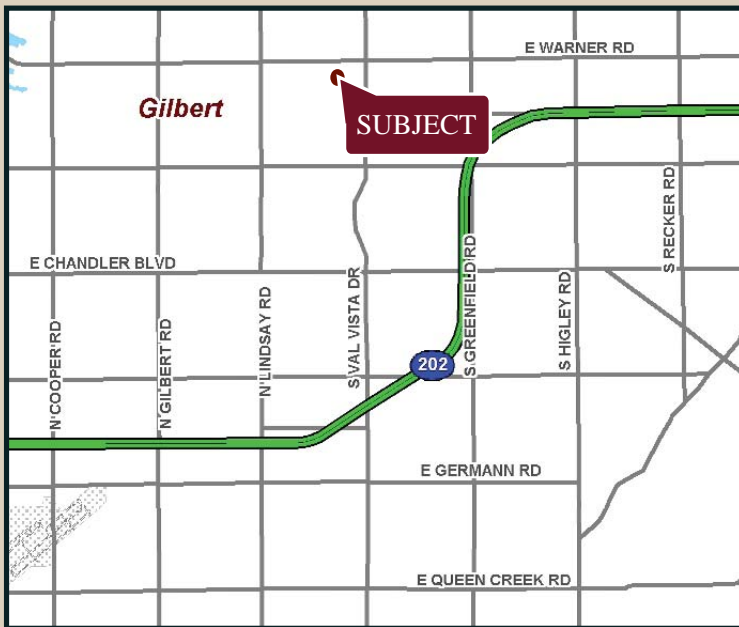

Monument Signage Available



AVAILABILITY

• 4,793 Square Feet

2010 Demographics	1 MILE	3 MILE	5 MILE
Estimated Population	18,306	118,659	321,076
Avg. Household Income	\$95,676	\$92,255	\$84,079
Daytime Employment	2,611	24,362	82,271

JOIN:



Information contained herein is believed to be accurate but is not warranted as to accuracy and may change or be updated without notice. Seller or landlord makes no representation as to the environmental condition of the property and recommends purchaser's or tenant's independent investigation.

EXCLUSIVELY REPRESENTED BY



MATT MILINOVICH
602.778.3830
mattm@srgaz.com

BRIAN GAST
602.792.5201
briang@srgaz.com

15169 N. Scottsdale Road Suite 330 Scottsdale, AZ 85254 602.778.3838(p) 602.778.3839(f)

VAL VISTA TOWNE CENTER

SOUTHWEST CORNER OF VAL VISTA DRIVE & WARNER ROAD, GILBERT, AZ



#	TENANT	SQ. FT.
1	Payless	3,200 sf
2	Sally Beauty	1,600 sf
3	Regis Salon	1,910 sf
4	Starbucks	1,774 sf
5	Ross Dress For Less	30,126 sf
6	Staples	23,848
7	Available	4,793 sf
8	Fantastic Sam's	1,300 sf
9	Port of Subs	1,300 sf
10	Orange Tree Yogurt	1,300 sf
11	Petco	13,221 sf

12	Dentist	2,551 sf
13	Bulls Eye	1,300 sf
14	La Nails	1,300 sf
15	Mortenson Chiropractic	1,150 sf
16	Body Heart Fitness Studio	1,750 sf
17	Edward Jones	949 sf
Pad 1	Papa Murphy's	
	2 B Wireless	
	Ice Cream	
	Game Stop	

EXCLUSIVELY REPRESENTED BY



STRATEGIC
RETAIL GROUP

MATT MILINOVICH
602.778.3830
mattm@srgaz.com

BRIAN GAST
602.792.5201
briang@srgaz.com

Val Vista Towne Center Trade Area





Summary Profile

1990 - 2000 Census, 2010 Estimates with 2015 Projections

Calculated using Proportional Block Groups

Lat/Lon: 33.33578/-111.7558

Val Vista Dr. & Warner Rd.

Gilbert, AZ

1 Mile

3 Miles

5 Miles

	1 Mile	3 Miles	5 Miles	
POPULATION	2010 Estimated Population	18,306	118,659	321,076
	2015 Estimated Population	22,051	137,628	379,957
	2000 Census Population	11,090	76,916	201,467
	1990 Census Population	637	23,490	87,723
	Historical Annual Growth 1990 to 2010	138.7%	20.3%	13.3%
	Projected Annual Growth 2010 to 2015	4.1%	3.2%	3.7%
	2010 Median Age	29.5	30.7	30.9
HOUSEHOLDS	2010 Estimated Households	5,354	35,594	98,725
	2015 Projected Households	6,383	40,891	115,149
	2000 Census Households	3,407	24,260	66,070
	1990 Census Households	187	7,097	28,491
	Historical Annual Growth 1990 to 2010	138.0%	20.1%	12.3%
	Projected Annual Growth 2010 to 2015	3.8%	3.0%	3.3%
POPULATION BY RACE	2010 Estimated White	90.0%	90.2%	89.4%
	2010 Estimated Black or African American	3.6%	3.4%	3.8%
	2010 Estimated Asian & Pacific Islander	5.1%	5.0%	5.1%
	2010 Estimated American Indian & Native Alaskan	0.2%	0.2%	0.3%
	2010 Estimated Other Races	0.6%	0.8%	1.0%
	2010 Estimated Hispanic	20.9%	21.7%	24.3%
INCOME	2010 Estimated Average Household Income	\$95,676	\$92,255	\$84,079
	2010 Estimated Median Household Income	\$83,970	\$79,391	\$72,421
	2010 Estimated Per Capita Income	\$28,097	\$27,721	\$25,940
EDUCATION (AGE 25+)	2010 Elementary	1.7%	3.1%	4.7%
	2010 Some High School	3.4%	4.3%	5.8%
	2010 High School Graduate	25.8%	24.0%	25.3%
	2010 Some College	35.3%	32.4%	32.3%
	2010 Associates Degree Only	14.0%	13.4%	12.5%
	2010 Bachelors Degree Only	29.9%	28.6%	26.1%
	2010 Graduate Degree	12.3%	13.8%	12.8%
BUSINESS	Number of Businesses	276	2,588	7,601
	Total Number of Employees	2,611	24,362	82,271
	Employee Population per Business	9.4	9.4	10.8
	Residential Population per Business	66.2	45.9	42.2

This report was produced using data from private and government sources deemed to be reliable. The information herein is provided without representation or warranty.